

PLAN FOR SEWER, POWER, WATER, FOR INDIVIDUAL PADS

- PLANT LIST**
- PINE TREES 6FT OR BETTER #2
  - FLOWERING TREES 5FT OR BETTER #3
  - FIVE GALLON FLOWERING SHRUBS #8
  - ROCK LANDSCAPING BOULDERS 2' TO 3' #6
  - GROUND COVER TO BE BARK OR THICK MULCH
  - TWO BURMS TO BE PLACED ON LOT SEE RENDERINGS FOR SIZES
  - A STOP & WASTE AND SHUT OFF VALVE INSTALLED ON EACH LOT WITH A 3/4" SPRINKLER & DRIP SYSTEM. SEE CROSS SECTION FOR DETAILS.

**ELECTRICAL NOTES:**

FOUR HIGH VOLTAGE LIGHTS TO BE INSTALLED ON LOT WITH A LIGHT SENSOR INSTALLED ON PEDESTAL. SEE PLAN FOR PLACEMENT.

ALL WIRES NEED TO BE IN CONDUIT AND BURIED NO LESS THAN 18" BELOW FINISHED GRADE.

**CONCRETE PAD INFO**

CONCRETE TO BE 5 BAG MIX 6" IN DEPTH WITH FIBERGLASS MESH.

PATIO SLAB TO BE 5 BAG MIX 4" IN DEPTH.

ALL PADS TO BE SAW CUT IN NO LESS THAN 10' X 10' SQUARES.

CONCRETE CURBING NEEDS TO CONTINUE THROUGH CONCRETE PAD. SEE CROSS SECTION (A-1) FOR DETAILS.

NOTE: BEFORE ANY PADS ARE POURED CONTACT AIRE RESORTS FOR PROPER INFO ON DRAINAGE, SLOPES AND GRADES.

NOTE:

ALL LIGHTING ON PADS TO BE 40 WATT OR LESS AND DOWN WARD FACING.

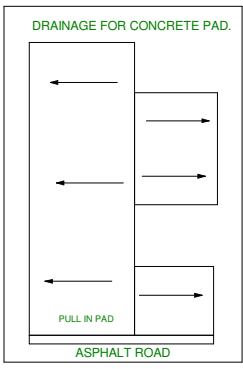
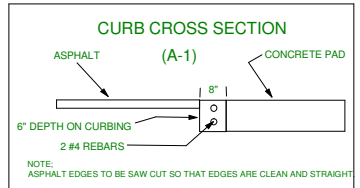

# EAGLES LANDING, STANDARD LOT

SCALE 1/4" = 1'-0"

AIRE MOTOR COACH RESORTS

**AIRE MOTOR COACH RESORTS,LLC**

2784 WEST SACKETT DR.  
 PARK CITY, UTAH 84098  
 OFFICE # (435) 655-9921  
 CELL # (435) 655-5500  
 FAX # (435) 649-2536

**CLIENT INFORMATION**

NAME	EAGLES LANDING
ADDRESS	
CONTACT	DOUG SORENSEN
CELL #	435 655-5500
FAX #	435-649-2536

CONTRACTOR & ALL SUB CONTRACTORS WORKING ON THIS PROJECT TAKE FULL LIABILITY OF THESE PLANS AND SHALL THOROUGHLY REVIEW AND VERIFY ALL DIMENSIONS, LOCATIONS, NOTES, ETC. PRIOR TO STARTING ANY STAGE OF CONSTRUCTION.

**AIRE MOTOR COACH RESORTS,LLC**

EXPRESSLY RESERVES ITS COMMON LAW COPYRIGHT AND OTHER PROPERTY RIGHTS IN THESE PLANS. THESE PLANS ARE NOT TO BE REPRODUCED, CHANGED, OR COPIED IN ANY FORM OR MANNER WHATSOEVER, NOR ARE THEY TO BE ASSIGNED TO A THIRD PARTY WITHOUT FIRST OBTAINING WRITTEN PERMISSION AND CONSENT OF AIRE MOTOR COACH RESORTS. IN THE EVENT OF UNAUTHORIZED REUSE OF THESE PLANS BY A THIRD PARTY, THE THIRD PARTY SHALL HOLD AIRE MOTOR COACH RESORTS HARMLESS.

SHEET #

1

Copyright: Reproduction of any portion of these plans for any purpose is strictly prohibited